



LAGOON SIXTY 5

Aboard the SIXTY 5, everything invites you to travel. The promise of becoming one with your boat to set sail on an adventure takes on full meaning. With elongated lines, this intrepid explorer, combines precision and finesse.

SPECIFICATIONS

BUILD
2021

LENGTH
20.55 m

BEAM
10.00 m

DRAFT
1,60 m

CABINS
4

ENGINES
2 X 175 HP Volvo Penta D4

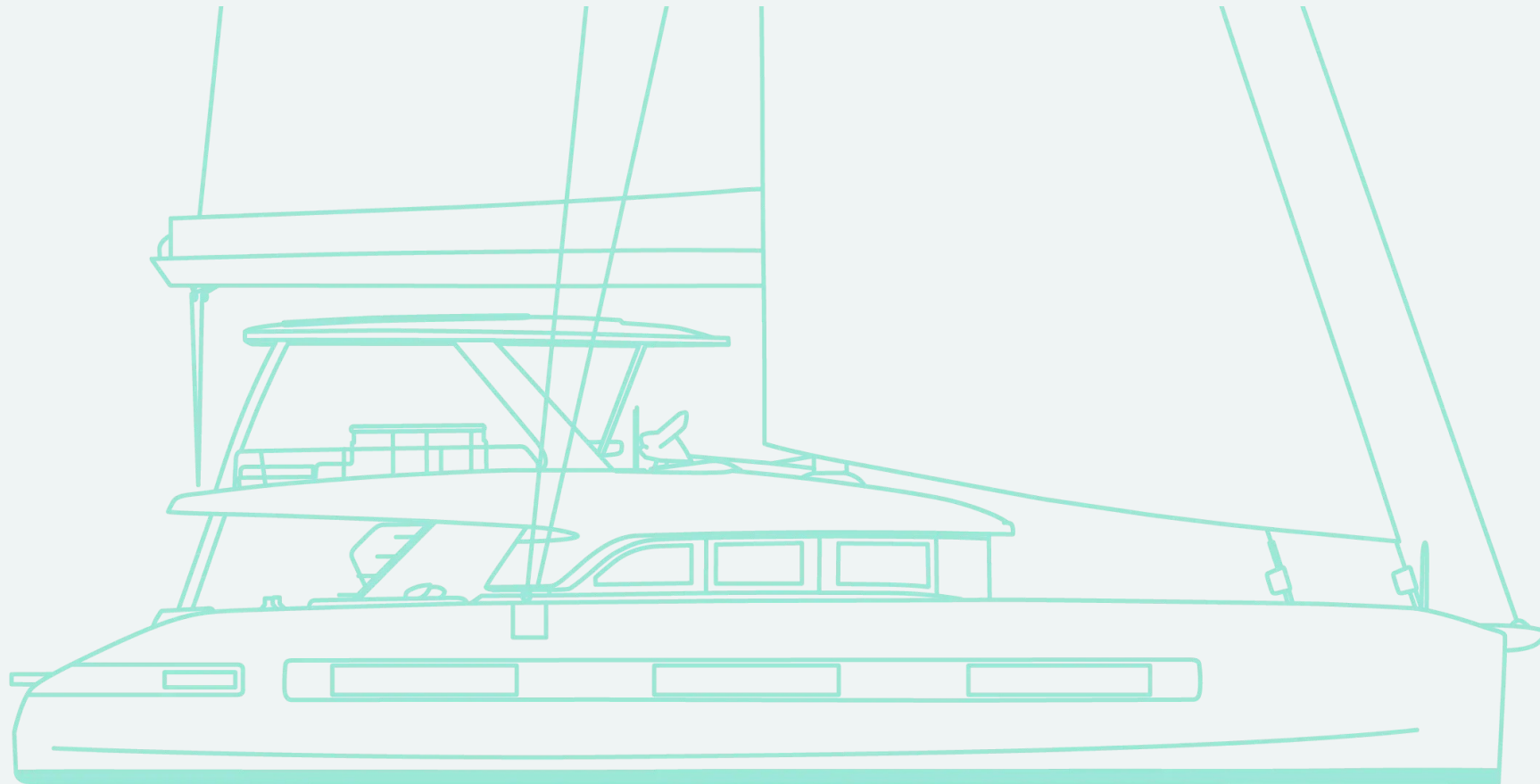

























































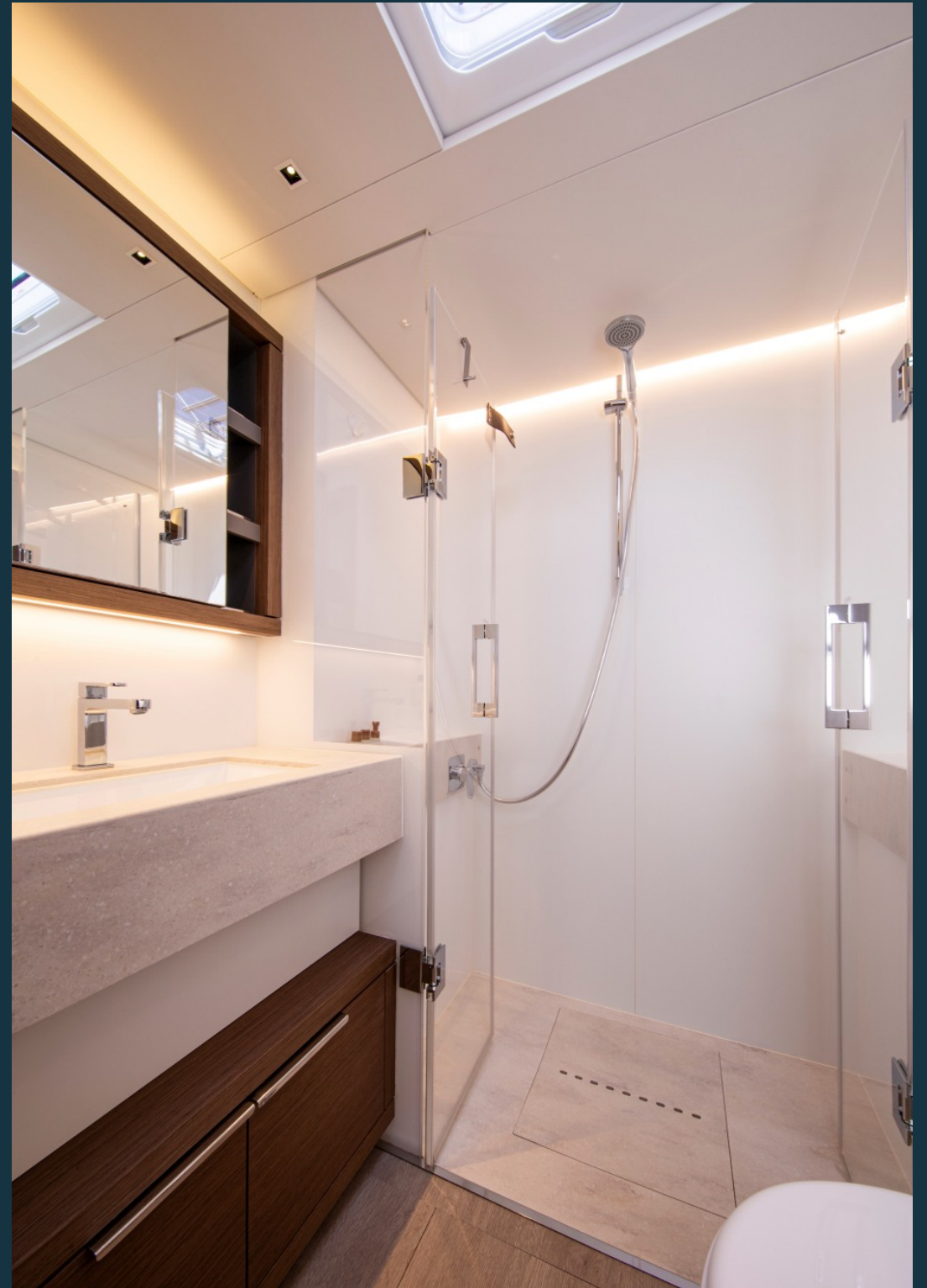

Description

As you step on board the Lagoon SIXTY 5 you will be able to appreciate her massive space. She is a comfortable and luxury home-away-from-home to eight guests. The flybridge is a beautifully appointed deck with two helm stations and unobstructed views. Kingfisher has a galley-down layout with four double cabins, each with a bathroom ensuite. It delivers the impressive main saloon space for the guests to enjoy. The aft cockpit and foredeck are great areas for entertaining and sunbathing.

Accommodations

The amount of space aboard the SIXTY 5 brings the catamaran to a new tier in the nautical industry. Relaxing, entertaining, and life aboard this yacht will impress all.

As you board the SIXTY 5 you will immediately feel how spacious the layout is. Her wide transom platforms and low stairs give an elevated fluidity throughout her decks to give comfortable access to her guests.

The SIXTY 5's elegant interior by the team at Nauta Design demonstrates their signature style of connection to nature. The open-flow layout and abundance of natural light encourage luxurious, connected living while on board.

The salon is bright and spacious with 360 degree views.

This same design concept has been applied throughout the entirety of the SIXTY 5, especially in the guest cabins.

With skylights overhead, an exceptional amount of natural light pours in from all angles of the cabin. As you move from space to space you feel the interior's harmony due to the same furnishings and finishes throughout the catamaran. The interior finish is Alpi walnut with open-grain varnish. In the main salon, a large dining table is positioned on the starboard side, with a L-shaped sofa and lounge area by a low coffee table on the port side. Kingfisher has a galley-down layout with four cabins. The salon features a bar area where owner and guests can enjoy breakfast or a snack, or prepare a drink during their stay.

With skylights overhead, an exceptional amount of natural light pours in from all angles of the cabin. As you move from space to space you feel the interior's harmony due to the same furnishings and finishes throughout the catamaran. The interior finish is Alpi walnut with open-grain varnish. In the main salon, a large dining table is positioned on the starboard side, with a L-shaped sofa and lounge area by a low coffee table on the port side. Kingfisher has a galley-down layout with four cabins. The salon features a bar area where owner and guests can enjoy breakfast or a snack, or prepare a drink during their stay.

With direct access from the salon to the forward terrace, the comfort never ends. This space features sofas and two sunbeds with a canopy to shade the lounge area. Perfect for diving gear and water toy storage, this area is versatile and can be whatever you make of it!

In terms of accommodations, the starboard aft side of the catamaran is completely dedicated to the owner's suite.

Combining our signature Lagoon luxury, comfort, and style, the owner's cabin is a particular highlight aboard the SIXTY 5. Utilizing and improving upon past designs, Lagoon has included the best features including a private terrace which gives the owner direct access to the sea and sun.

Forward of this side of the hull lies a double VIP cabin which offers its guests a private dressing area, a full length mirror, and an impressively spacious shower.

Opposite, in the port hull to aft, is a private galley that has direct cockpit access. The galley is fully equipped with top notch, full sized appliances including a Miele microwave, Miele built-in coffee machine, Miele dishwasher, Miele washer/dryer, electric stove and oven, double fridge, double sink and a secondary freezer in the floor to safely refrigerate your catch of the day! Forward on this side of the hull, with private access are two comfortable guest cabins with bathroom ensuite.

The flybridge is an essential living area. With two helm stations on either side, the flybridge on the SIXTY 5 has unobstructed views. The bimini is even fitted with glass allowing the skipper to keep an eye on the hoisted sails. This means visibility of all angles at the helm. On the flybridge is a space with everything you need; a large, comfortable sofa with a reclining backrest for lounging, spacious lockers underneath for storage, a large dining table and a wet bar with a plancha grill, a fridge, and cutlery lockers...the SIXTY 5's flybridge has it all.

Crew quarters for up to four crew are found in the forward port and starboard forepeaks, each with private access.

Rigging and sails

- On Kingfisher the sail wardrobe is comprised of a Hydromesh mainsail, staysail and genoa. The mainsail is the optional square top version. A Code 0 D4 Kevlar Gold with electric furling has been added to the base sail plan.
- Her hull comes equipped with an alu Sparcraft mast and Park Avenue carbon boom for our performance-focused owners. With smooth and easy handling, her sailing assets and performance underway are sure to meet the highest of expectations.
- Upgraded 2-speed electric winches have been installed for ease of handling plus a 3-speed main halyard winch.
- All winches are Harken. Spectra running rigging.

Exterior features

- Teak on aft deck, side decks, foredeck and flybridge.
- Hydraulic platform aft.
- Hydraulic gangway starboard aft.
- Retractable swimladder.
- Shower on portside aft platform.
- Underwater lights.
- Removable curtains around aft deck.
- Flybridge bimini with glass panels, curtains and lighting.
- Electric grill on flybridge.
- Bow Thruster.
- Varifold propellers with rope cutters on shafts.

Engines and electrical systems.

- Twin Volvo D4 175HP.
- Main generator Onan 19kVA 230V/50Hz
- Second generator Onan 13kVA 230V/50Hz
- Batteries:
 - 6 Service batteries 1050Ah / 24V - GEL
 - 2 Engine starter batteries 75A 12V
 - 1 Battery shut-off (house battery bank) in the forward port companionway.
 - Three Dolphin battery chargers 100Amp
 - Two Victron converters 5kVA 24/230V.
 - Yacht management monitoring system

Galley

- Comfortable galley with seating area for four and exit to aft cockpit.
- American style Refrigerator 80L/Freezer 100L.
- Extra freezer under floor.
- Dishwasher Miele.
- Washer/dryer Miele.
- 4-burner induction Miele.
- Microwave combi-oven Miele.
- Integrated coffee machine.
- Extractor fan.

Electronics

- B&G VHF, Radar, AIS, Plotter multiple function screens. Autopilot with remote control. Forward scan depth sounder. Dual systems for back-up: second radar Furuno, second VHF ICON, second AIS.
- Hifi media center with 55"TV folding down from ceiling in the salon.
- Hifi media center with 43"TV on lift in owner's cabin.
- Stereo/speakers: cockpit aft, cockpit forward, salon, flybridge.
- Omnimax radio/tv antenna in mast

Additional Information

- Watermaker 280L/H Sea Recovery Aquamatic
- Seagull IV water purifier in galley.
- Reversible AC in all areas.
- Deckwash pump, fresh and salt water.
- Capstan port and starboard aftdeck.
- Safety equipment for 12 PAX including two 8P liferafts, 9 fire-extinguishers plus fire-extinguishing system in engine rooms.
- Hydraulic steering
- Toilets electric Tecnomar
- Brunton folding props
- Bowthruster Sidepower
- Aftcockpit and flybridge can be totally enclosed by screens
- Quick electric anchorwinch, 100m chain.
- Hydraulic passerelle.

Tender

- Highfield 460 RIB with a 70HP Yamaha outboard.

LAYOUT



LAYOUT

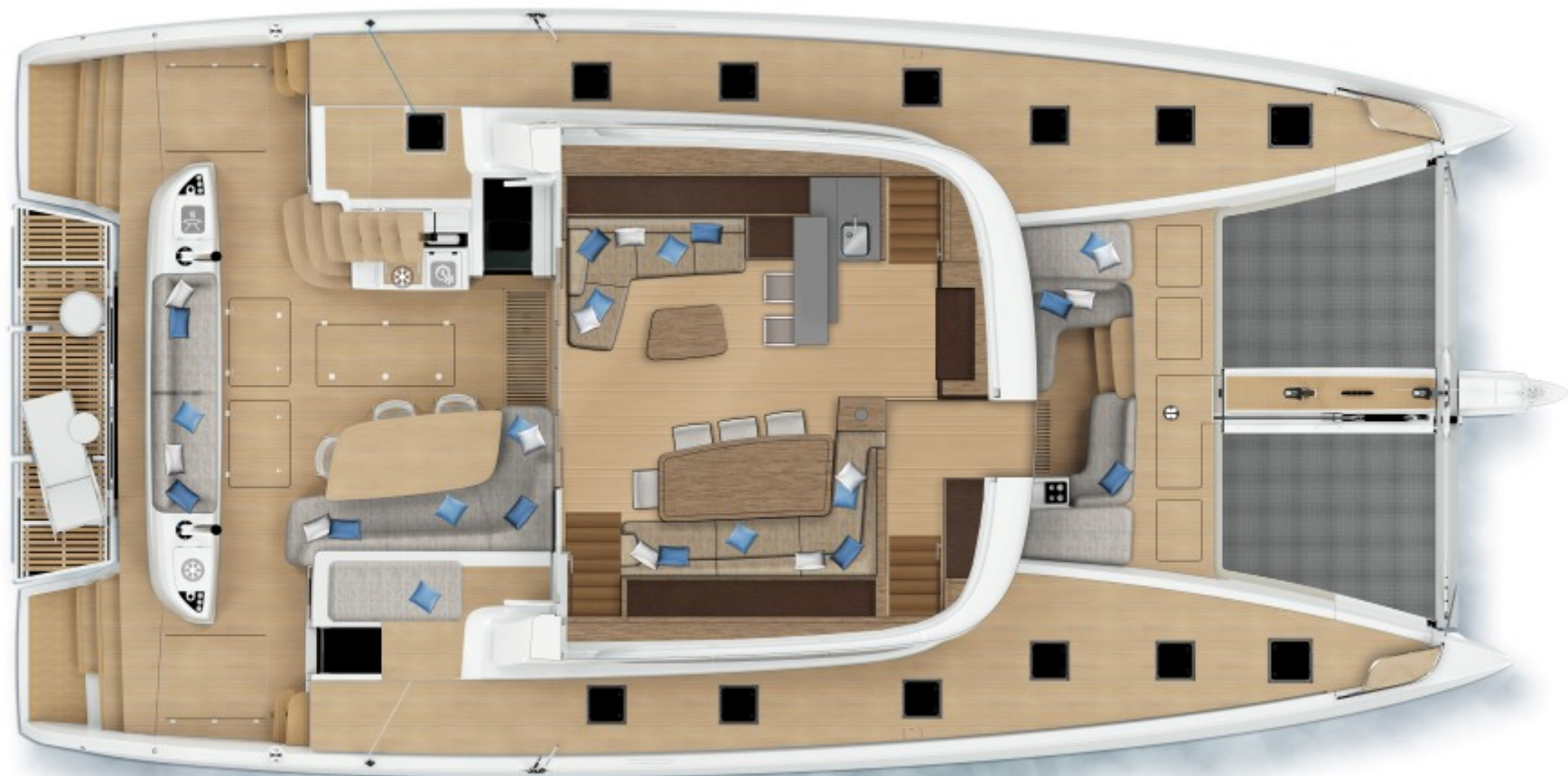

LAYOUT

